

0 10M 20M

NOTE:
RED LINE BOUNDARY DEMONSTRATES EXTENT OF
PLANNING APPLICATION BOUNDARY

SBC & RDC BOUNDARY INDICATED BY GREEN
LINE

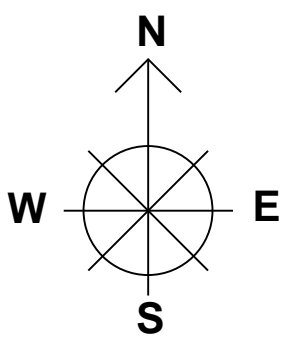

ROCHFORD DISTRICT COUNCIL

SOUTHEND BOROUGH COUNCIL

NOTE: HATCHED AREA -
FOR DETAILS OF ACCESS IMPROVEMENTS IN THIS AREA
SEE DRAWING Y321_PL_DR_201 REV B

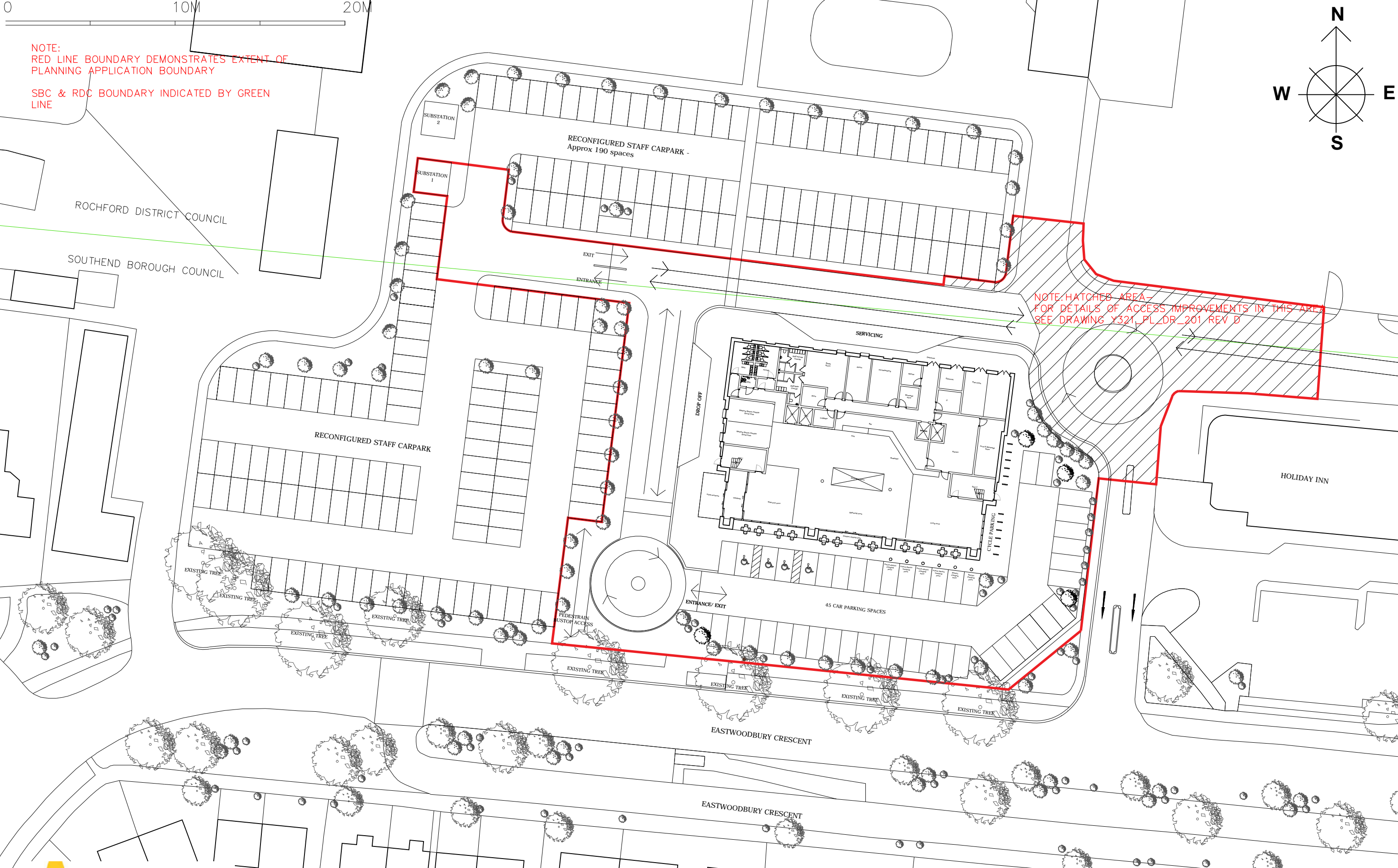

Aros

Aros Architects
Jerwood Space
171 Union Street
London SE1 0LN

Telephone
+44(0)20 7928 2444
Facsimile
+44(0)20 7928 2450

Email
info@arosarchitects.com
Website
www.arosarchitects.com

Notes

1. All dimensions are to be verified by the Contractor on site, any discrepancies in this drawing are to be reported to Aros Ltd.
2. The Contractor shall not vary any work shown on this drawing without prior approval in writing from Aros Ltd.
3. The Contractor shall supply a full set of shop drawings and specifications prior to commencement of work.
4. This drawing supersedes all previous issues of the same drawing number with an earlier revision suffix.
5. The Contractor shall immediately inform Aros Ltd of the effect upon the programme and costs of any alterations to the proposed works shown on this drawing.
6. This drawing is the copyright of Aros Ltd and the contents must not be disclosed to other parties without prior agreement.

Revisions

| Rev | Date | Drawn | Checked | Description |
|-----|----------|-------|---------|-------------|
| | XX.XX.XX | | | |

Project
London Southend Airport
Title
Proposed Site Plan

Project No
6126
Date
March 2020
Status
Planning

Drawing No
(20) 001 (1)
Scale
1:500 @ A3
Rev
P5